

MONACO COMPONENTS, INC.

MECHANICAL / ELECTRONIC SOLID STATE BUZZER

**9000
series**

- Small size and lightweight.
- Wide operating voltage range.
- Long life.

MODEL	MTF-9248	MTF-9249	MTF-9250	MTF-9251	MTF-9252	MTF-9253
OPERATING FREQUENCY *	400 Hz \pm 100 Hz					
DRIVING CIRCUIT	BUILT IN					
OPERATING VOLTAGE	1 - 3 V	2 - 4 V	4 - 8 V	6 - 12 V	9 - 15 V	15 - 27 V
RATED VOLTAGE	1.5 V	3 V	6 V	9 V	12 V	24 V
SOUND PRESSURE *	70 dBA MIN. @ 20 cm		75 dBA MIN. @ 20 cm			
CURRENT CONSUMPTION *	20 mA MAX.	25 mA MAX.				30 mA MAX.
tone	CONTINUOUS					
CONNECTION STYLE	PCB MOUNT (PINS)					
OPERATING TEMPERATURE	-10° to +60° C					

* VALUES AT RATED VOLTAGE

MTF-9248
MTF-9249
MTF-9250
MTF-9251
MTF-9252
MTF-9253

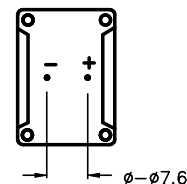
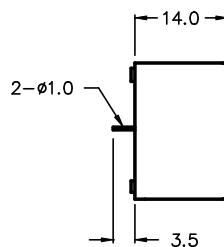
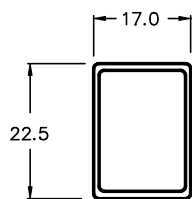

ALL DIMENSIONS IN mm

SPECIFICATIONS SUBJECT TO CHANGE WITHOUT NOTIFICATION / MODELS SHOWN SUBJECT TO LIMITED WARRANTY

SALES OFFICE (516)-767-6644

CORPORATE OFFICE

P.O. Box 575, Scotch Plains, NJ. 07076

Phone: (908)-322-2977 Fax: (908)-322-2358

E-mail: info@monacocomponents.com

www.monacocomponents.com