

MONACO COMPONENTS, INC.

EXTERNAL DRIVE STYLE ELECTRO-MAGNETIC

**7000
series**

- Sealed and washable.
- Wide temperature and voltage ranges.
- Rich sound output.

MODEL	MMF-7200	MMF-7202	MMF-7204
RATED VOLTAGE	5 V	6 V	12 V
OPERATING VOLTAGE	3 - 5 V	3 - 8 V	8 - 14 V
RATED CURRENT *	80 mA MAX.	70 mA MAX.	55 mA MAX.
COIL RESISTANCE	27 ± 4 OHMS	36 ± 5 OHMS	120 ± 15 OHMS
DRIVE CIRCUIT	EXTERNAL		
COIL IMPEDANCE **	38 OHMS	48 OHMS	155 OHMS
SOUND PRESSURE *	85 dBA MIN. @ 10 cm		
RESONANT FREQUENCY	730 Hz	-	
REPRODUCED FREQUENCY	-	1000 - 1500 Hz (80 dB MIN.)	
TONE	DEPENDENT ON DRIVE CIRCUIT USED		
CONNECTION STYLE	PCB MOUNT (PINS)		
OPERATING TEMPERATURE	-40° to +85° C		

* VALUE APPLYING RATED VOLTAGE : **MMF-7200** : 730Hz, 1/2 DUTY SQUAREWAVE
MMF-7202 : 1000Hz, 1/2 DUTY SQUAREWAVE
MMF-7204 : 1000Hz, 1/2 DUTY SQUAREWAVE

** VALUE APPLYING 1000 Hz, SINEWAVE, MEASURING 60 MICRO-AMPS

MMF-7200
MMF-7202
MMF-7204

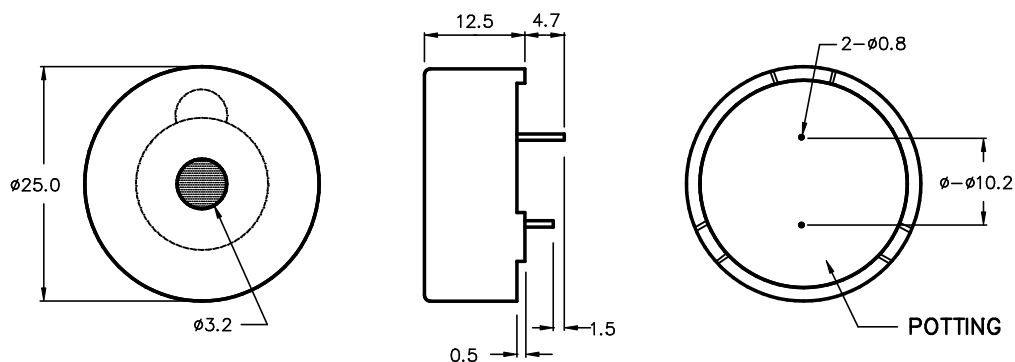

NORYL SEI-GFN2 HOUSING MATERIAL
 SEALED AND WASHABLE

ALL DIMENSIONS IN mm

SPECIFICATIONS SUBJECT TO CHANGE WITHOUT NOTIFICATION / MODELS SHOWN SUBJECT TO LIMITED WARRANTY

SALES OFFICE (516)-767-6644

CORPORATE OFFICE

P.O. Box 575, Scotch Plains, NJ. 07076

Phone: (908)-322-2977 Fax: (908)-322-2358

E-mail: info@monacocomponents.com

www.monacocomponents.com