

MONACO COMPONENTS, INC.

EXTERNAL DRIVE STYLE ELECTRO-MAGNETIC

**7000
series**

- Ultra-miniature design.
- Rich sound output.

MODEL	MMF-7000	MMF-7100	MMF-7100 N
RATED VOLTAGE	1.5 V		
OPERATING VOLTAGE	1 - 2 V		
RATED CURRENT *	80 mA MAX.	30 mA MAX.	
COIL RESISTANCE	5.5 ± 1.0 OHMS	16.0 ± 4.5 OHMS	
DRIVE CIRCUIT	EXTERNAL		
COIL IMPEDANCE **	9.5 OHMS	40 OHMS	
SOUND PRESSURE *	85 dBA MIN. @ 10 cm	80 dBA MIN. @ 10 cm	
RESONANT FREQUENCY	3100 Hz	2048 Hz	
tone	DEPENDENT ON DRIVE CIRCUIT USED		
CONNECTION STYLE	PCB MOUNT (PINS)		
OPERATING TEMPERATURE	-20° to +60° C		

MMF-7000 : NORYL SEI HOUSING MATERIAL

- * VALUE @ RATED VOLTAGE (3100 Hz, 1/2 DUTY SQUAREWAVE)
- ** 3100 Hz, SINEWAVE; 60 MICRO-AMPS

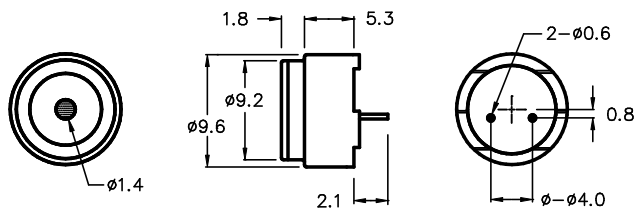

MMF-7100 : ABS HOUSING MATERIAL

- MMF-7100 N : NORYL SEI HOUSING MATERIAL
- * VALUE @ RATED VOLTAGE (2048 Hz, 1/2 DUTY SQUAREWAVE)
- ** 2048 Hz, SINEWAVE; 60 MICRO-AMPS

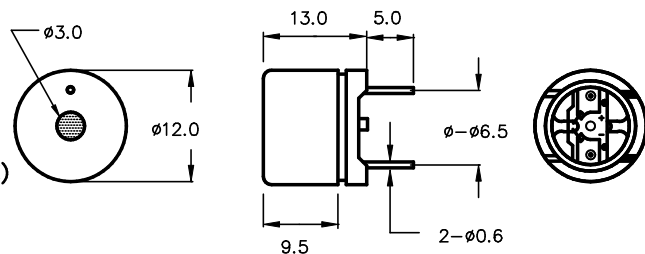

ALL DIMENSIONS IN mm

SPECIFICATIONS SUBJECT TO CHANGE WITHOUT NOTIFICATION / MODELS SHOWN SUBJECT TO LIMITED WARRANTY

SALES OFFICE (516)-767-6644

CORPORATE OFFICE

P.O. Box 575, Scotch Plains, NJ. 07076

Phone: (908)-322-2977 Fax: (908)-322-2358

E-mail: info@monacocomponents.com

www.monacocomponents.com