

# MONACO COMPONENTS, INC.

## SELF-DRIVEN STYLE

**6000  
series**

- High sound output.
- Low current drain.
- High efficiency.

MODEL	MPF-6310
RESONANT FREQUENCY	3500 Hz $\pm$ 500 Hz
OPERATING VOLTAGE	3 - 16 V
RATED VOLTAGE	6 V
DRIVE CIRCUIT	SELF DRIVEN
SOUND PRESSURE *	80 dBA MIN. @ 30 cm
CURRENT CONSUMPTION *	5 mA MAX.
CONNECTION STYLE	LEADS
OPERATING TEMPERATURE	-20° to +60° C

\* VALUES @ RATED VOLTAGE USING REFERENCE DRIVE CIRCUIT

The current consumption and sound pressure level are measured by using a reference drive circuit. This is only one example.

MPF-6310

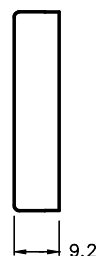
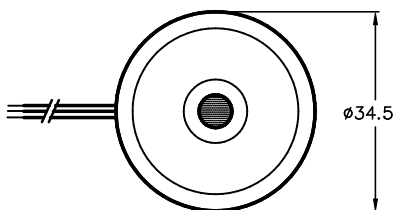

ALL DIMENSIONS IN mm

SPECIFICATIONS SUBJECT TO CHANGE WITHOUT NOTIFICATION / MODELS SHOWN SUBJECT TO LIMITED WARRANTY

**SALES OFFICE (516)-767-6644**

CORPORATE OFFICE

P.O. Box 575, Scotch Plains, NJ. 07076

Phone: (908)-322-2977 Fax: (908)-322-2358

E-mail: [info@monacocomponents.com](mailto:info@monacocomponents.com)

[www.monacocomponents.com](http://www.monacocomponents.com)